

Cast iron butterfly valve PN16

Semi lugged, to BS EN 593:2004, face to face dimensions to BS EN 558:2008

SIZES

Flange connections

Range	DN65	DN80	DN100	DN125	DN150	DN200	DN250	DN300
Code	BR 316	BR 317	BR 318	BR 319	BR 320	BR 321	BR 322	BR 323

*Geared wheel operation, V906G

DIMENSIONS (mm)

Range	DN65	DN80	DN100	DN125	DN150	DN200	DN250	DN300
A	46	46	52	56	56	60	68	78
B	70	89	106	120	132	164	200	238
C	181	187	211	226	239	293	469	494
D	200	200	290	290	290	450	341	341
Weight kg	4.40	5.00	6.10	8.00	9.60	15.10	31.5	50.5

FLOW RATES (m³/h)

Range	DN65	DN80	DN100	DN125	DN150	DN200	DN250	DN300
Kv	229.32	353.34	702.00	1195.74	1874.43	3669.12	6247.8	9652.5

VALVE SUITABILITY

Steam	Water	Oil	Air	Gas Inert	Gas Combustible	Gas Corrosive	Gas Oxygen
✗	✓	✗	✗	✗	✗	✗	✗

MATERIAL SPECIFICATION

Component	
Body	Cast Iron
Shaft	Stainless Steel
Disc	Stainless Steel
Bushes up to 100mm	PTFE
Bushes up to 125mm	Gunmetal
'O' Ring	EPDM
Liner	EPDM

MAXIMUM PRESSURE CONDITIONS

Size	Maximum Pressure Conditions (bar)		Test Pressures (bar)	
	Temperatures up to 120°C	Temperatures up to 120°C	Shell	Seat
DN65 to DN300	16.0	16.0	24	17.6
Size	Maximum Pressure Conditions (psi)		Test Pressures (psi)	
	Temperatures up to 248°F	Temperatures up to 248°F	Shell	Seat
DN65 to DN300	232.1	232.1	348.1	253.8

Temperature range -10°C - +120°C

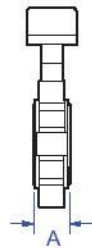
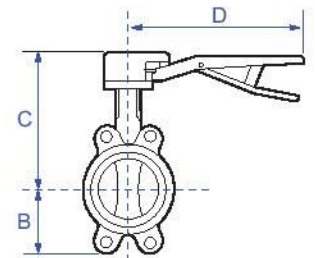

PRESSURE EQUIPMENT DIRECTIVE CATEGORY

Sizes

DN65	DN80	DN100	DN125	DN150	DN200	DN250	DN300
SEP	SEP	SEP	SEP	SEP	SEP	SEP	SEP

PRESSURE & TEMPERATURE RATINGS

