

Brass full bore quarter turn ball valve

male x female, PN25

SIZES

Parallel Thread

Range	3/8"	1/2"	3/4"	1"	1 1/4"	1 1/2"	2"
MF IS07-1Rp (PT) internal IS0228-1 external	242150	242151	242152	242153	242154	242155	242156
MFT IS07-1Rp (PT) internal IS0228-1 external	242160	242161	242162	242163			

DIMENSIONS (mm)

Range	3/8"	1/2"	3/4"	1"	1 1/4"	1 1/2"	2"
A MF	53	57	69	81	97	103	127
B MF	35	39	50	55	62	78	84
Weight kg	0.155	0.218	0.382	0.574	0.891	1.272	2.074
A MFT	53	57	69	81			
B MFT	37	40	51	55			
Weight kg	0.137	0.197	0.356	0.555			

FLOW RATES (m³/h)

Range	3/8"	1/2"	3/4"	1"	1 1/4"	1 1/2"	2"
Kv MF/MFT	9.40	17.0	41.0	70.0	121.0	200.0	292.0

*Kv - flow rate in m3 per hour at a pressure drop of 1 bar.

VALVE SUITABILITY

	Steam	Water	Oil	Air	Gas Inert	Gas Combustible	Gas Corrosive	Gas Oxygen
MF/MFT	✗	✓	✓	✓	✗	✗	✗	✗

Air maximum - 10 bar

MATERIAL SPECIFICATION

Component	
Body	Brass, Chrome plated
End Piece	Brass, Chrome plated
Ball	Brass, Chrome plated
Stem	Brass Bar
Seats	PTFE
Lever Handle	Steel
Friction Washer	PTFE
'O' Ring Seats	Viton
Rating disc	Aluminium

MAXIMUM PRESSURE CONDITIONS

Size	Maximum Pressure Conditions (bar)		Test Pressures (bar)	
MF/MFT	Temperatures up to 100°F	Temperatures up to 150°C	Shell	Seat
3/8" to 2"	25.0	16.5	37.5	27.5
Size	Maximum Pressure Conditions (psi)		Test Pressures (psi)	
MF/MFT	Temperatures up to 212°F	Temperatures up to 302°F	Shell	Seat
3/8" to 2"	362.6	293.3	543.9	398.9

Temperature range - 10°C + 150°C (non shock)

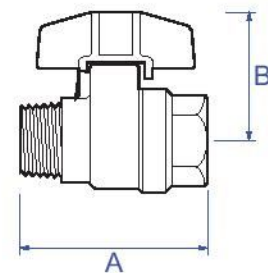
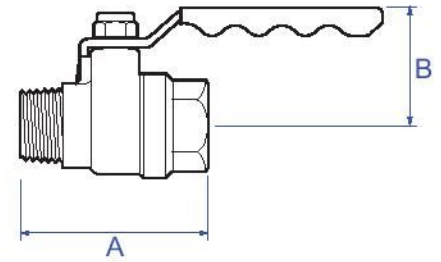

PRESSURE EQUIPMENT DIRECTIVE CATEGORY

Sizes		3/8"	1/2"	3/4"	1"	1 1/4"	1 1/2"	2"
MF	SEP	SEP	SEP	SEP	SEP	SEP	SEP	SEP
MFT	SEP	SEP	SEP	SEP				

PRESSURE & TEMPERATURE RATINGS

