

Brass Full bore quarter turn ball valve

Blue lever, female ends, PN25

SIZES

Taper / American (NPT) Taper

Range	1/4"	3/8"	1/2"	3/4"	1"	1 1/4"	1 1/2"	2"	2 1/2"	3"	4"
IS07-1Rc (Taper)	242001	242002	242003	242004	242005	242006	242007	242008	242009	242010	242011
ANSI (NPT) (Taper)			242043	242044	242045	242046	242047	242048	242049	242050	242051

DIMENSIONS (mm)

Range	1/4"	3/8"	1/2"	3/4"	1"	1 1/4"	1 1/2"	2"	2 1/2"	3"	4"
A Face to Face	48	48.5	59	67.5	79.5	95	100	122	150	177	214
B Centre Line to Lever	35	35	39	50	55	62	77.5	84	97	122	136
Weight kg	0.15	0.15	0.23	0.4	0.61	0.95	1.33	2.18	3.75	6.20	10.45



FLOW RATES (m³/h)

Range	1/4"	3/8"	1/2"	3/4"	1"	1 1/4"	1 1/2"	2"	2 1/2"	3"	4"
Cv			19.9	48.0	81.9	141.6	234.0	341.6	626.0	994.5	1591.2
Kv	5.9	9.4	17.0	41.0	70.0	121.0	200.0	292.0	535.0	850.0	1360.0

*Cv - flow rate in US GPM at a pressure drop of 1 psi.

*Kv - flow rate in m3 per hour at a pressure drop of 1 bar.

VALVE SUITABILITY

Steam	Water	Oil	Air	Gas Inert	Gas Combustible	Gas Corrosive	Gas Oxygen
X	✓	✓	✓	X	X	X	X

Air maximum - 10 bar

MATERIAL SPECIFICATION

Component	
Body	Forged brass, Chrome plated (1/4" to 2") Gravity die cast brass, Chrome plated (2 1/2" to 4")
End Piece	Forged brass (1/4" to 2") Gravity die cast brass (2 1/2" to 4")
Ball	Brass bar, Chrome plate (1/4" to 1/2") Forged Brass, Chrome plated (3/4" to 2") Gravity die cast brass, Chrome plated (2 1/2" to 4")
Stem	Brass bar
Seats	PTFE (Teflon)
Thrust Washer	PTFE (Teflon)
Stem 'O' ring	Viton
Red Lever	High temperature PVC insulated zinc plate steel
Nut (Self locking)	Zinc plated steel

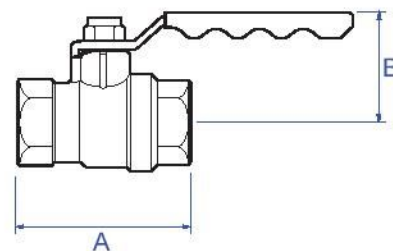

MAXIMUM PRESSURE CONDITIONS

Size	Maximum Pressure Conditions (bar)		Test Pressures (bar)	
	(Cold working) Temperatures up to 100°C	(Hot working) Temperatures up to 150°C	Shell	Seat
1/4" to 4"	25.0	16.5	37.5	27.5
Size	Maximum Pressure Conditions (psi)		Test Pressures (psi)	
	Temperatures up to 212°F	Temperatures up to 302°F	Shell	Seat
1/4" to 4"	362.6	293.3	543.9	398.9

Temperature range - 10°C + 150°C (non shock)

PRESSURE EQUIPMENT DIRECTIVE CATEGORY

Sizes											
1/4"	3/8"	1/2"	3/4"	1"	1 1/4"	1 1/2"	2"	2 1/2"	3"	4"	
SEP	SEP	SEP	SEP	SEP	SEP	SEP	SEP	SEP	SEP	SEP	SEP

PRESSURE & TEMPERATURE RATINGS

